

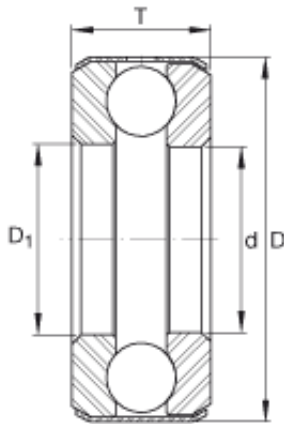

Suau Konrakansurin Ltd.

INA B3 Ball Thrust Bearings & Washers



Bearing No. B3

Size	15.875x34.138x15.875 mm
Bore Diameter	15,875 mm
Outer Diameter	34,138 mm
Width	15,875 mm
d	5/8 inch
d	15,875 mm
D	1,344 inch
D	34,138 mm
T	0,625 inch
T	15,875 mm
D ₁	0,656 inch
m	0,154 lbs / Weight
m	0,07 kg / Weight
C _a	4100 lbf / Dynamic load rating (axial)
C _a	18200 N / Dynamic load rating (axial)
C _{0a}	6700 lbf / Static load rating (axial)
C _{0a}	29800 N / Static load rating (axial)
Category	Thrust Ball Bearing
Inventory	0.0
Manufacturer Name	SCHAEFFLER GROUP
Minimum Buy Quantity	N/A
Weight / Kilogram	0.07
EAN	4047643177856

B3 Bearing 2D drawings and 3D CAD models



Suau Konrakansurin Ltd.

Product Group	B00308
Rolling Element	Ball Bearing
Thrust Bearing	Yes
Single or Double Direction	Single Direction
Banded	Yes
Precision Class	ABEC 1 ISO P0
Component Description	Roller Assembly Plus Raceways
Other Features	Single Row Deep Groove Medium Cross Section Grooved Race Non Separable Full Complement Standard Oil Hole in Band
Long Description	5/8" Bore 1; 21/32" Bore 2; 1-11/32" Outside Diameter; 5/8" Height; Ball Bearing; Single Direction; Banded; ABEC 1 ISO P0 Precision
Inch - Metric	Inch
Category	Thrust Ball Bearings
UNSPSC	31171507
Harmonized Tariff Code	8482.10.50.08
Noun	Bearing
Keyword String	Ball Thrust
Manufacturer URL	http://www.ina.com
Manufacturer Item Number	B3
Weight / LBS	0.154
Outside Diameter	1.344 Inch 34.138 Millimeter
Overall Height with Aligning Washer	0 Inch 0 Millimeter
Bore 1	0.625 Inch 15.875 Millimeter
Height	0.625 Inch 15.875 Millimeter



Suau Konrakansurin Ltd.

Bore 2

0.656 Inch | 16.662
Millimeter